

# VSR-TL-B

---

V-Stabilizer™ for a Tower, large leg size (8–16 in)

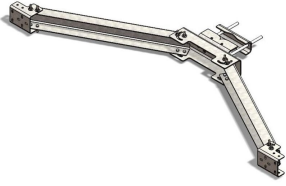

## Product Classification

**Product Type** Reinforcement kit

## General Specifications

**Mounting** Angle 60°, 406.4 mm (16 in) | Angle 90°, 304.8 mm (12 in) | Straight or tapered legs up to 406.4 mm (16 in) OD

**Pipe, quantity** 0

**Tower Taper** Non-tapered | Tapered

## Dimensions

**Face Width** 4.42 m | 14.5 ft

**Length** 1,320.8 mm | 52 in

**Mounting Diameter, maximum** 406.4 mm | 16 in

**Mounting Diameter, minimum** 203.2 mm | 8 in

## Material Specifications

**Material Type** Hot dip galvanized steel

## Packaging and Weights

**Included** Clamps | Legs

**Packaging quantity** 1

**Weight, net** 67.086 kg | 147.9 lb

## Regulatory Compliance/Certifications

Agency	Classification
ISO 9001:2015	Designed, manufactured and/or distributed under this quality management system

# VSR-TL-B

---

